

Craftsman,Farmhouse/National Folk, Detached - VIENNA, VA



\$ 2,299,888

1ST FLOOR

TOTAL FINISHED SPACE: 2,501 SF
 BR: 216 SF
 GARAGE: 450 SF
 DECK: 333 SF

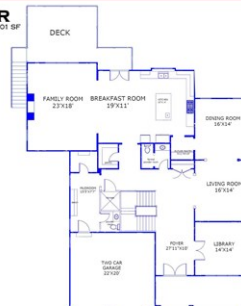

2ND FLOOR

TOTAL FINISHED SPACE: 3,017 SF
 TWO STORIES: 66 SF

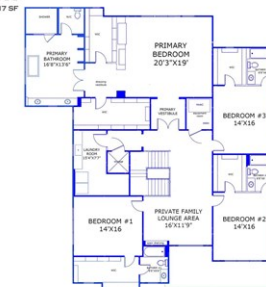

BASEMENT

TOTAL SPACE: 2,433 SF

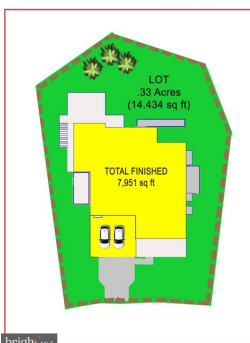

1205 ROSS DRIVE SW, VIENNA, VA 22180

- » Beds: 5 | Baths: 5 Full, 3 Half
- » MLS #: VAFX2098752
- » Single Family | 7,951 ft² | Lot: 14,375 ft²
- » More Info: 1205ROSSDRIVESW.IsForSale.com



Red Door Metro
 of Keller Williams Realty
 (703) 906-2881 (Main)
 1 (844) 596-3876 (Toll Free)
 clientcare@reddoormetro.com
 http://www.reddoormetro.com



Red Door Metro
 1775 Tysons Blvd
 Suite 1450
 McLean, VA 22102
 (703) 564-4000

Create the life you've dreamed of within AR Design Groups next masterpiece. Situated in sought after Town Of Vienna, where the options are plentiful but none compare to this Private 1/3 acre lot backing to woods located at 1205 Ross Drive SW. This beautiful private lot features nearly 8000 sq ft of exquisite craftsmanship. Upper level flows beautifully with a Custom Built Family Lounge & 4 Sun-Drenched bedrooms each including their own Walk-in Closet & Private Bath. Your Secluded Master Bedroom comes ready for relaxation with your Spa bathroom and Large Picturesque Over-sized Windows overlooking your private backyard. Your Fully Finished Lower Level features a Private Theater, Gym, 2nd Office & a Full Bedroom Suite. Invest in the value of a daily lifestyle that connects you to the community around while enjoying luxurious living. Time to customize features from AR Design Group's 8k sq ft showroom and design center with Delivery expected Fall 2023! **3D Tour & Pics are of Past Projects w/examples of finishes expected**

